

# b31

*by Hr Hr*

---

**Submission date:** 02-Apr-2023 09:31AM (UTC+0700)

**Submission ID:** 2053153723

**File name:** B31.pdf (1.33M)

**Word count:** 2909

**Character count:** 15236

PAPER · OPEN ACCESS

## Stress analysis on the frame holder of generator translation motion on horizontal direction for sea wave power plant using finite element method (fem)

14  
To cite this article: A. Indriani *et al* 2020 *IOP Conf. Ser.: Mater. Sci. Eng.* **909** 012033

1  
View the [article online](#) for updates and enhancements.

### You may also like

- 3  
- Novel Nonrotational Piston Gauge with  
3  
3  
- Light Balance Mechanism for the  
Measurement of Small Differential  
Pressures  
A Ooiwa
- 3  
- Geometry design and optimization of  
piston by using finite element method  
Z R Lee and P X Ku
- 9  
- Sliding force investigation of a free piston  
permanent magnet linear generator  
I I Abdalla, A. E Z Zainal, N A Ramlan et  
al.

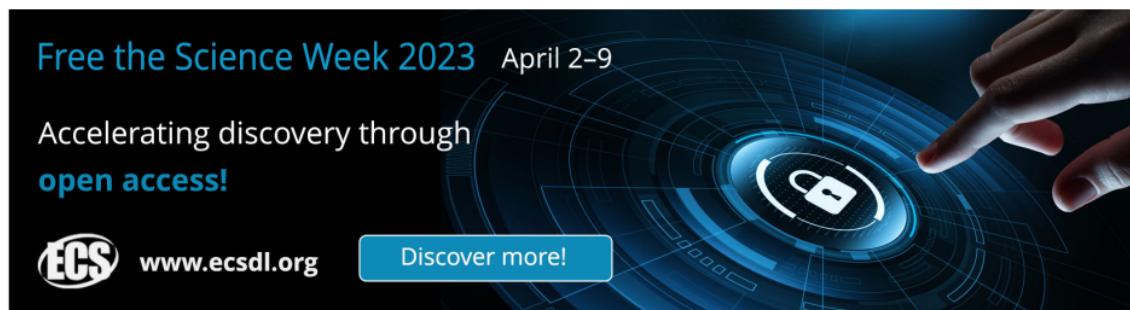

Free the Science Week 2023 April 2-9

Accelerating discovery through  
open access!

 [www.ecsdl.org](http://www.ecsdl.org) [Discover more!](#)

The banner features a dark blue background with a futuristic, glowing blue interface. A hand is shown interacting with a circular element containing a white padlock icon. The text is in white and light blue, with the ECS logo and website URL in white.

## Stress analysis on the frame holder of generator translation motion on horizontal direction for sea wave power plant using finite element method (fem)

A. Indriani<sup>1,\*</sup>, Hendra<sup>2</sup>, Yenni S.<sup>1</sup>, Aswata, W.<sup>2</sup>, Rispani<sup>3</sup>, Hernadewita<sup>4</sup> and A. Tanjung<sup>5</sup>

<sup>1</sup>Electrical Engineering Dept. University of Bengkulu, Indonesia

<sup>2</sup>Mechanical Engineering Dept. University of Sultan Ageng Tirtayasa Banten, Indonesia

<sup>3</sup>Mechanical Engineering Dept. University of Bengkulu, Indonesia

<sup>4</sup>Industrial Engineering Dept. University of Mercubuana, Indonesia

<sup>5</sup>Polytechnic State of Padang, Indonesia

Jl. W. R. Supratman Kandang Limun, Bengkulu, Indonesia

Email: h7f1973@yahoo.com

**Abstract.** The generator is a machine component that converts mechanical energy into electrical energy. Generators can be found in power generation systems. In this paper, generators are used on the sea wave power plants [1-4]. This generator works by utilizing the effects of ocean waves that rise and fall so as to push the piston to move in the same direction with ocean waves. The performance of the generator is influenced by the magnitude of the force of the piston, rotors and stator. Stable, rigid and smooth piston movements also can increase generator output performance. The design and material of the generator holder is very influential on the generator stiffness. Generator stiffness includes deformation and stress that occur and can be obtained using the finite element method (FEM) [5-13]. In this paper focus on simulating the generator holder shape horizontal direction and the amount of deformation and stresses by varying frame holder generator shape and inclination ( $75^{\circ}$ ,  $80^{\circ}$ ,  $90^{\circ}$ ). In previous studies, the translational motion generator frame holder design is less rigid (stable). From the simulation results, the maximum voltage value ( $\sigma_{max}$ ) of von mises is 6,427 MPa, the deflection value is 61.29 mm with  $90^{\circ}$  generator stand design positions.

### 1. Introduction

The generator is a machine component that converts mechanical energy into electrical energy. Generators can be found in power generation systems such as hydropower, wind, diesel, ocean waves and others. In this paper, generators are used on the sea wave power plants [1-4]. The generator works by utilizing the effects of ocean waves that rise and fall so as to push the piston to move in the same direction with ocean waves (pneumatic). Generator for ocean waves can be found in the pelamis mechanism, pneumatic system [1-4], and etc. [1]. Pneumatic system has been use in generator by translation motion system on vertical direction [2-4]. The working principle of translational and rotation motion generator in horizontal direction is to utilize the mechanism of piston work down and up due to thrust force or load. Piston in the generator translation and rotation consist on shafts that have been fitted with pole winding magnet (coil) that move on down and up (rotor). Up and down movements of the coil



Content from this work may be used under the terms of the Creative Commons Attribution 3.0 licence. Any further distribution of this work must maintain attribution to the author(s) and the title of the work, journal citation and DOI.

Published under licence by IOP Publishing Ltd

meet with neodymium magnets which are arranged along the generator tube (stator) will be produce magnetic electric energy. In the rotation generator motion system uses a shaft rotation which is connected to the gears of the translator generator piston motion.

The performance of the generator is influenced by the thrust force of the piston up and down, the rotor and stator material, the number of rotors and stators, magnets, coils and others. Stable, rigid and smooth piston movements also can increase generator output performance. The mechanism of generator of translation and rotation motion requires a strong, stiffness, toughness, constant and stable generator holder to get the good output of generator. The movement and strength of piston up and down is influenced by the thrust force of piston, piston material, generator holder and generator holder material.

The design of the Frame of generator holder and the type of material is very influential on the generator stiffness. Generator stiffness includes deformation and stress that occur where the rigid generator will produce small stress and deformation. The amount of deformation and the voltage that occurs at the frame holder of generator translation and rotation can be obtained using the finite element method (FEM) [5-13].

In this study focus on stress and deformation happen on the frame holder of generator translation and rotation motion on horizontal direction and amount of deformation and stresses that occur using variations a generator holder material, generator holder shape, inclination angles of frame holder of generator. Inclinations angles of frame holder of generator  $75^0$ ,  $80^0$ ,  $90^0$  and random are used to evaluate of the performance of generator translation and rotation on horizontal direction and also to solving problem for low skill operator in manufacture the frame of generator holder. In previous studies the inclination angle of frame of generator is random and the result of generator translation and rotation motion generator design is less rigid (unstable) and low precision so that it affects the performance of the generator [2]. The research focus on the stress analysis using finite element method (FEM) analysis is applied to calculate stress and deformation on the design of frame holder of generator before manufacturing process [5-13]. By FEM analysis its obtain good design of frame holder of generator depend on the load and maximum stress that occurs on the frame holder of generator and also reduce of cost production for manufacturing.

**Table 1.** Properties of material frame holder of generator [5-13]

Material	Young's Modulus (GPa)	Poisson's Ratio	Tensile Strength (MPa)
Steel	210	0.3	330
Cast Iron	120	0.3	758

## 2. Method

FEM analysis is applied to calculate stress in the frame holder of generator translation and rotation motion on horizontal direction. 3D model has been used for this analysis [5, 10] and variation of inclination angle are  $75^0$ ,  $80^0$ ,  $90^0$  and random is applied in this frame holder of generator. Material of frame holder of generator is steel and cast iron. Figure 1 show the generator translation and rotation motion on horizontal direction and Fig. 2 show the design of frame holder of generator by 3 type depend on variation of inclination angles (random,  $75^0$  and  $90^0$ ). Variation load is applied at the frame holder of generator using 1000 N to 10 kN. Table 1 shows the material properties of steel, and cast iron. Figure 2 shows the 3D model of design of generator translation and rotation on horizontal direction with total number of elements is 245832 and nodes is 443465.

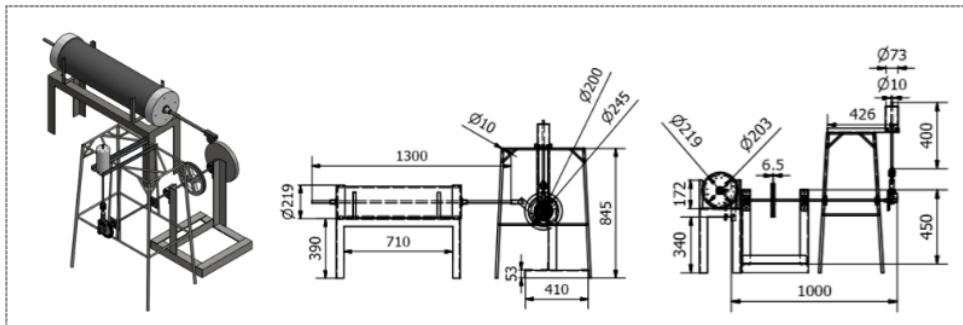

Figure 1. Design of generator translation and rotation motion on horizontal direction



a. Random b. Inclination angle 80° c. Inclination angle 90°

Figure 2. Design of frame holder of generator by varying inclination angles.

**Design of Frame of Generator Horizontal Motion by Varying of Inclination Angles**

Random 80° 90°

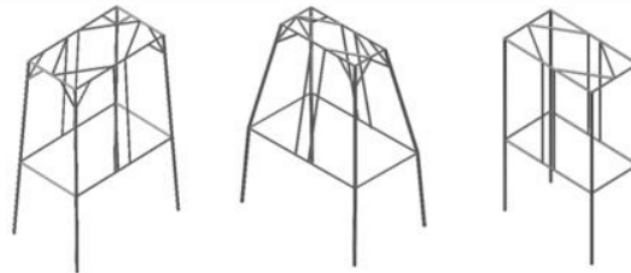

Stress ( $\sigma_{max}$ )	6.44 MPa	6.40 MPa	6.37 MPa
Displacement ( $\delta_{max}$ )	(0,062 mm)	(0,057 mm)	(0,056 mm)

Figure 3. Maximum stress and deformation value on design of frame of generator translation and rotation motion on horizontal direction

### 3. Result and Discussions

Results of simulation of stress and deformation for design of frame holder of generator translation and rotation motion on horizontal direction by FEM analyze can be seen at Figs. 3-8. Stress and deformation value of frame holder of generator by varying of inclination angle of frame holder can be seen in Table

2. As shown in Table 2, the value of maximum stress and deformation of frame holder by inclination angle  $90^0$  is smaller than value stress on random inclination angle. The maximum stress value is 6.34 MPa and deformation value is 0.056 mm for inclination angle  $90^0$ . And for random inclination angle is 6.44 MPa and 0.062 mm. This results show that the stress and deformation for inclination angle  $90^0$  is better than other varying of inclination angle of frame holder of generator.

**Table 2.** Maximum stress and deformation value on design of frame of generator translation and rotation motion on horizontal direction

NO	Force (N)	$\sigma_{max}$ (MPa)						
		$\sigma_{xx}$	$\sigma_{xy}$	$\sigma_{xz}$	$\sigma_{yy}$	$\sigma_{yz}$	$\sigma_{zz}$	$\sigma_{vm}$
1	1000	54,49	16,98	21,27	27,82	9,13	23,51	64,41
2	2000	108,8	33,95	42,54	55,53	18,26	47,01	128,7
3	4000	217,2	67,91	85,07	110,5	36,54	94	257
4	5000	271,8	84,89	106,3	138,5	45,66	117,6	321,5
5	6000	327,7	101,9	127,5	167,6	54,76	141	386,9
6	8000	435,1	135,8	170,2	222	73,05	188	514,7
7	10.000	544	169,8	212,7	277,6	91,3	235,1	643,4

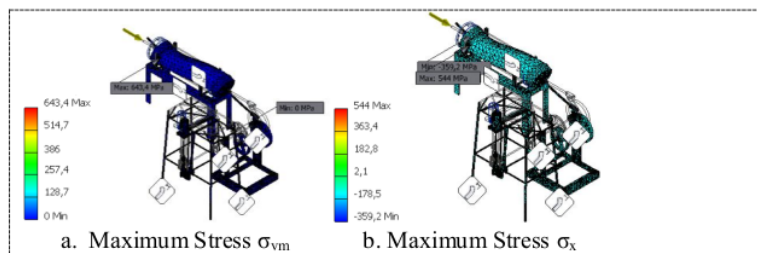

**Figure 4.** Stress distribution of drum rotary.

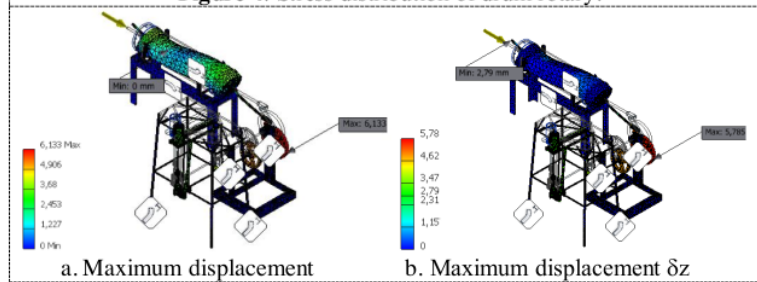

**Figure 5.** Displacement distribution of drum rotary for fem

Table 2 show the value of maximum stresses for frame holder of generator with random inclination angle. The maximum stress Von Misses value is 64.41 MPa with load 1000 N and increasing to 643.4 MPa with load 10 kN. Maximum stress appear at  $\sigma_{xx}$  with value 54.49 MPa with load 1000 N on Z direction. When the load is increasing maximum stress value become increase 544 MPa for load 10 kN and also deformation is increasing with higher of load. This happen due to the load give significant effect on the stress and deformation, when the load is high then stress and deformation become increase. To reduce the stress and deformation can be done by using ribbing, selection of material for frame holder of generator and using inclination angle  $90^0$ .

The stress and deformation distribution of frame holder of generator translation and rotation motion on horizontal direction with random inclination angle can be seen in Fig. 3. Figure 3 show that the position of maximum stress and deformation appear at the insert of tube generator ( $\sigma_{xx}$ ). The blue colour show the condition of stress have minimum value of stress (compression) and red colour is maximum value of stress (tensile). The maximum stress appear in the insert tube of generator due to the thrust force as a input for driven a generator that start from this part. The maximum deformation appear at the Z direction with value 5.78 mm by using load 10 kN.

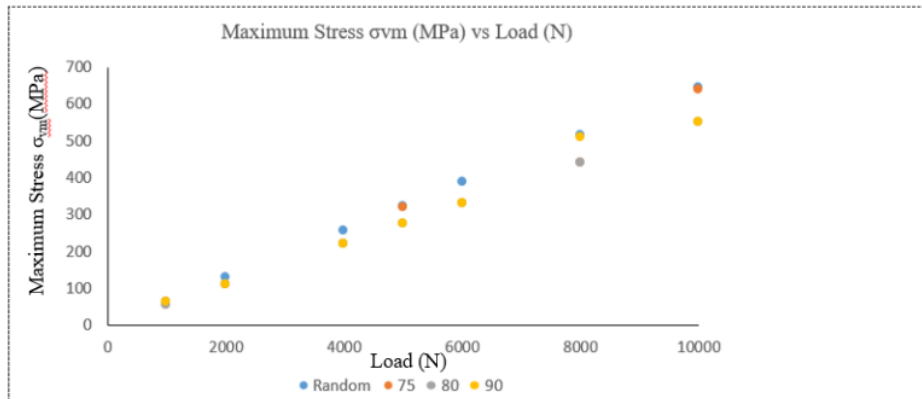

Figure 6. Maximum stress for varying load and inclination angle of frame holder of generator

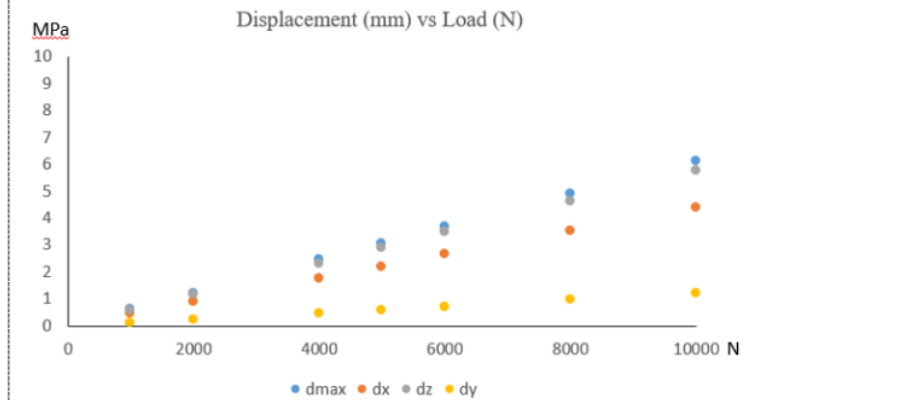
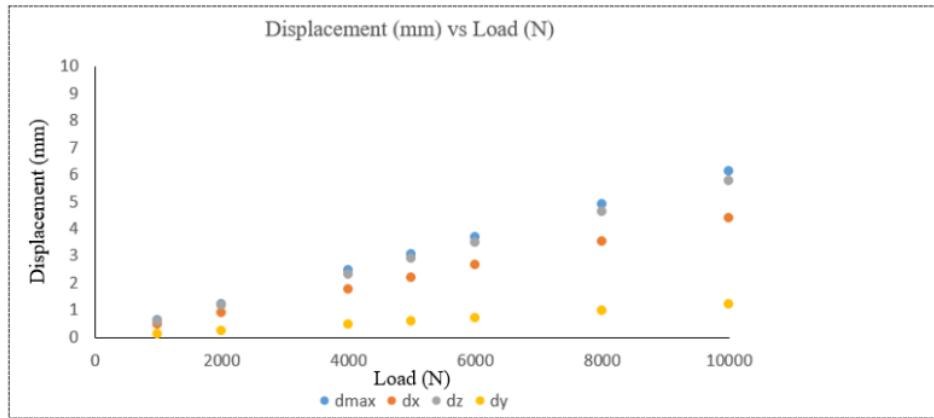

Figure 7. Maximum deformation for varying load and inclination angle of frame holder of generator.

Figure 5 show that maximum stress for frame holder of generator depend on variation load and frame holder inclination angles. Maximum stress have bigger value at frame holder inclination angle is random and become smaller using  $90^\circ$ . For addition of load, the maximum stress become higher when the value load is big. Maximum stress for random inclination angle is similar with  $75^\circ$  compare with  $80^\circ$  and  $90^\circ$ . The maximum deformation appear at the random inclination angle of frame holder on z direction as shown in Figs. 6 and 7. This figure show that when the value of inclination angle smaller than  $90^\circ$  and the load increase then maximum stress and deformation become increase. This result show that load and frame holder inclination angle for structure of generator is significant give effect on the stress and deformation.



**Figure 8.** Position maximum deformation for varying load and inclination angle of frame holder of generator.

#### 4. Conclusions

Steel and cast iron material been used in frame holder of generator translation and rotation motion on horizontal direction. Frame holder of generator have some requirement such as stiffness, toughness, stable, stress, deformation and etc. The stress and deformation of frame holder of generator depend on the load, shape of frame, inclination angle and etc. To get this requirement therefore finite element method are used to calculate design of frame holder of generator by variation load and inclination angle of frame holder. The conclusions can be made in the following:

1. The maximum stress of frame holder of generator translation and rotation motion on horizontal direction for random inclination angle is higher than  $90^{\circ}$ . The maximum stress value is 644 MPa with load 10 kN. For  $90^{\circ}$  inclination angle of frame holder maximum stress is 637 MPa. The maximum deformation for  $90^{\circ}$  inclination angle is smaller compare with other inclination angle (random,  $75^{\circ}$  and  $80^{\circ}$ ).
2. Maximum stress and deformation become higher when the load is increasing and value of inclination angle smaller than  $90^{\circ}$ .
3. Maximum stress in the frame holder of generator appear at insert of tube piston ( $\sigma_x$ ) and maximum deformation in Z direction on the disk of piston.

#### 5 Acknowledgments

This research support by Ministry Research, Technology/ Head of the National Research and Innovation Agency Republic of Indonesia through Hibah Penelitian Dasar Unggulan Perguruan Tinggi (PDUPT) 2020 Number 165/SP2H/LT/DRPM/2019 and Number 791/UN30.15/AMD/LT/2020, and Institution of Research and Community Service University of Bengkulu.

#### 5.2 References

- [1] Hendra, Indriani, A., Hernadewita Applying of Piston Mechanism Design In The Wavelength Electrical Generating of Ocean For Fishing Community *Advanced Materials Research* **918** 2014-01-01.
- [2] Indriani, A., Darmana, I., Hernadewita, Setiawan, A., Hendra 2020 Control Output of Generator Translation and Rotation Using Buck Boost Converter for Sea Wave Power Plant *International Journal of Mechanical Engineering and Technology* **11** Issue 5 61-74.
- [3] Indriani, A., Dimas, S., Hendra 2018 Effect of Dimension and Shape of Magnet on the Performance AC Generator with Translation Motion *IOP Conference Series: Materials Science and Engineering* **307** Issue 1.



- [4] Indriani, A., Hendra, Suhartini, Y., Tanjung, A. 2019 Performance of Generator Pneumatic for Power Plant of Ocean Wave *IOP Conference Series: Materials Science and Engineering* 505 Issue: 2
- [5] Hendra, Syukriah, Silalahi, M., Hernadewita, Hermiyetti 2019 Finite Element Method Analysis for Manufacturing Design Drum Dryer of Rotary Dryer Machine *IOP Conference Series: Materials Science and Engineering* 505 Issue: 1. 6
- [6] Tsuyunaru, M., Noda, N. A., Hendra and Takase, Y. 2008 Maximum Stress for Shrink Fitting System used for Ceramics Conveying Rollers *Transactions of the Japan Society of Mechanical Engineering* 74 919-925. 11
- [7] Tsuyunaru, M., Noda, N. A., Hendra and Takase, Y. Maximum stress for shrink fitting system used for ceramics conveying rollers, *Nihon Kikai Gakkai Ronbunshu A Hen Transactions of the Japan Society of Mechanical Engineers* 74 Issue : 7. 7
- [8] Noda, N. A., Hendra, Oosato, M., Suzumoto, K., Takase, Y., and Li, W. 2011 Strength Analysis For Shrink Fitting System Used For Ceramics Rolls In The Continuous Pickling Line *Key Engineering Materials* 462-463 1140-1145. 17
- [9] Harada, S., Noda, N. A., Uehara, O. and Nagano, M. Tensile Strength of Hot Isostatic Pressed Silicon Nitride and Effect of Specimen Dimension *Transactions of the Japan Society of Mechanical Engineering* 57 No.539 1991. 10
- [10] Takase, Y., Li, W., Hendra, Ogura, H., Higashi, Y. And Noda, N.A. 2011 Three-Dimensional Surface Heat Transfer Coefficient and Thermal Stress Analysis for Ceramics Tube Dipping into Molten Metal *Advances in Fracture and Damage Mechanics IX, Key Engineering Materials* 452-453 233-236 (Trans Tech Publications, Switzerland). 10
- [11] Noda, N. A., Hendra, Takase, Y., and Li, W. 2009 Thermal Stress Analysis for Ceramics Stalk in the Low Pressure Die Casting Machine *Journal of Solid Mechanics and Material Engineering* 3 1090-1100. 10
- [12] Noda, N. A., Yamada, M., Sano, Y., Sugiyama, S., and Kobayashi, S. 2008 Thermal Stress for All-ceramics Rolls used in Molten Metal to Produce Stable High Quality Galvanized Steel Sheet *Engineering Failure Analysis* 15 261-274. 12
- [13] Noda, N.-A., Hendra, Li, W., Takase, Y., Ogura, H., Higashi, Y. 2013 Thermal stress and heat transfer coefficient for ceramics stalk having protuberance dipping into molten metal, *Nihon Kikai Gakkai Ronbunshu A Hen Transactions of the Japan Society of Mechanical Engineers* 79 Issue 802. 7

## ORIGINALITY REPORT

16%

SIMILARITY INDEX

13%

INTERNET SOURCES

9%

PUBLICATIONS

6%

STUDENT PAPERS

## PRIMARY SOURCES

1	<a href="http://eprints.untirta.ac.id">eprints.untirta.ac.id</a> Internet Source	2%
2	<a href="http://scopedatabase.com">scopedatabase.com</a> Internet Source	2%
3	M L Skryabin, A V Grebnev. "Promising methods for strengthening piston aluminum alloys of heat engines", Journal of Physics: Conference Series, 2020 Publication	1%
4	<a href="http://www.i-sim.org">www.i-sim.org</a> Internet Source	1%
5	Hendra, Pudi Virama, Hernadewita, Dhimas Satria, Hermiyetti, Frengki Hardian. "Analyze of Geometric Characteristic of Powder Reinforced Composite Material from Liquid Waste for Part of Motor Vehicle", Materials Science Forum, 2022 Publication	1%
6	Submitted to cheshirecollegesouthandwes Student Paper	1%

7	<a href="http://www.researchgate.net">www.researchgate.net</a> Internet Source	1 %
8	<a href="http://sintadev.ristekdikti.go.id">sintadev.ristekdikti.go.id</a> Internet Source	1 %
9	F R Ismagilov, V E Vavilov, V I Bekuzin, V V Ayguzina. "Determination of Specific Losses in Stator Core of Electromechanical Energy Converter", IOP Conference Series: Earth and Environmental Science, 2017 Publication	1 %
10	<a href="http://www.scientific.net">www.scientific.net</a> Internet Source	1 %
11	Xiangmin Zhou. "Publications on Thermal Stresses", Journal of Thermal Stresses, 05/2008 Publication	1 %
12	<a href="http://www.j3.jstage.jst.go.jp">www.j3.jstage.jst.go.jp</a> Internet Source	1 %
13	<a href="http://repository.unair.ac.id">repository.unair.ac.id</a> Internet Source	<1 %
14	<a href="http://docplayer.net">docplayer.net</a> Internet Source	<1 %
15	<a href="http://www.coursehero.com">www.coursehero.com</a> Internet Source	<1 %
16	<a href="http://uhra.herts.ac.uk">uhra.herts.ac.uk</a> Internet Source	

<1 %

---

17 N Sakai. Superconductor Science and  
Technology, 06/2000

Publication

<1 %

---

18 www.sataban.com

Internet Source

<1 %

---

19 keep.lib.asu.edu

Internet Source

<1 %

---

20 m.iopscience.iop.org

Internet Source

<1 %

---

Exclude quotes Off

Exclude matches Off

Exclude bibliography Off